

TSSOP 16
CASE 948AH i01
ISSUE O

DATE 19 SEP 2008

SEE DETAIL "A"

0.19

0.09

4.30

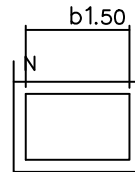

COMMON DIMENSIONS	
NOM.	MAX.
—	1.10
—	0.15

A₂
b
b1
c
c1
D
E1
C
E
L

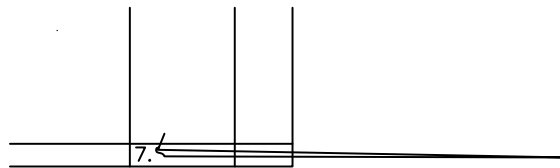

SEE VA

0.65 BSC	
6.40 BSC	
0.60	0.70

JNS IN MILLIMETERS

SEE VARIATIONS
| — | 8°

MOLD FLASH OR PROTRU