

WLCSP6, 0.58x2.19x0.265
CASE 567XY
ISSUE C

DATE 23 JUN 2021

NOTES:

1. DIMENSIONING AND TOLERANCING PER ASME Y14.5M, 1994.
2. CONTROLLING DIMENSION: MILLIMETERS
3. DATUM C, THE SEATING PLANE, IS DEFINED BY THE SPHERICAL CROWNS OF THE CONTACT BALLS.
4. COPLANARITY APPLIES TO THE CONTACT BALLS.

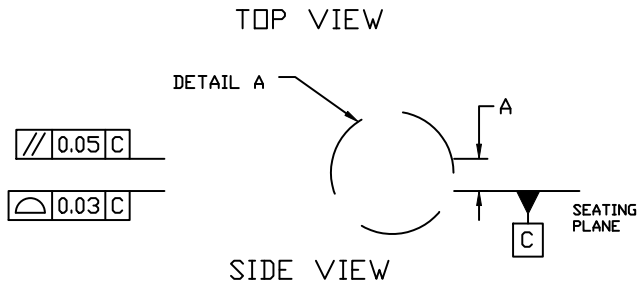

MILLIMETERS			
DIM	MIN.	NOM.	MAX.
A			0.29
A1	0.04 REF		

b	0.12	0.17	0.22
D	0.58		
E	2.19		
0.			

2

1 3

BOTTOM VIEW

