

**WLCSP15, 2.36x1.05**  
**CASE 567BP-01**  
**ISSUE O**

DATE 26 JUL 2010

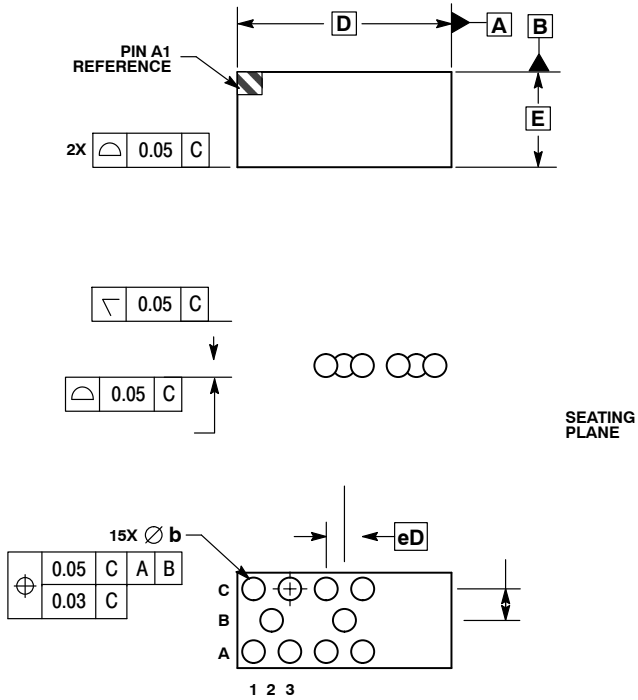

NOTES:

1. DIMENSIONING AND TOLERANCING PER ASME Y14.5M, 1994.
2. CONTROLLING DIMENSION: MILLIMETERS.
3. COPLANARITY APPLIES TO SPHERICAL CROWNS OF SOLDER BALLS.

MILLIMETERS	
DIM	MIN MA
A	0.57 0.7
A1	

<b>DOCUMENT NUMBER:</b>	<b>98AON498</b>
<b>DESCRIPTION:</b>	<b>WLCSP15,</b>

$b$	0.24	0.49
$D$	2.36	BSC
$E$		
$eD$	0.400	BSC

ON Semiconductor and are trademarks of Semiconductor Components Industries, LLC. ON Semiconductor reserves the right to make changes without notice to the suitability of its products for any particular purpose, nor does it disclaim any and all liability, including without limitation special, incidental or consequential damages, arising out of the use of its products.

© Semiconductor Components Industries, LLC, 2019

